

Needle Clamp

> Product description

The Needle Clamp is a pithole repair clamp and is the the appropriate solution to repair small corrosion pits in steel pipes.

No surface preparation is required and a simple wrench is sufficient to install the clamp.

The needle guides the tip of the conical rubber gasket to enter the corroded area.

By tightening the plug, the rubber gasket sufficiently compresses to seal off the leak.

Maximum working pressure is 2000 psi (138 bar).

The Needle Clamp can be installed by your own personnel.

> Material specifications

Standard Clamp Components

| | |
|-------------------------|--------------------------|
| Body | Stainless Steel AISI 304 |
| Stud Bolts | A193 Gr. B7 |
| Nuts | A194 Gr. 2H |
| Gasket (4) | NBR or VITON |
| Pilot pin (1) | SS 316 |
| Packing force screw (2) | ASTM A105, galvanized |
| Thrust washer (3) | Brass |
| Dual dia pin (5) | SS 316 |



weld cap

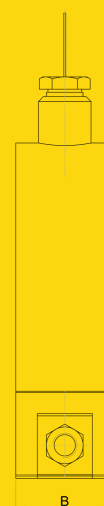
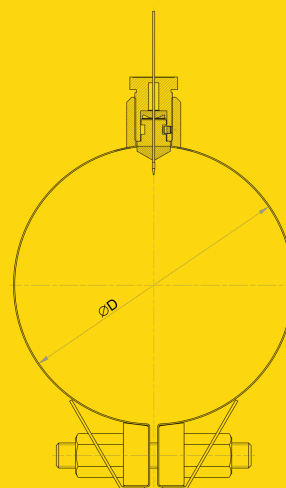

Offices and factory:
Kerkdijk-Zuid 11a
5492 HW Sint Oedenrode
The Netherlands

T +31 88 765 44 50
F +31 88 765 44 51
E sales@romaconpetro.com